

**TORRE MELINA**  
— A GRAN MELIÀ HOTEL —  
BARCELONA



  
**PALAU DE CONGRESSOS  
DE CATALUNYA** BARCELONA  
MANAGED BY MELIÀ HOTELS INTERNATIONAL



CAPACITIES & FLOOR PLANS

# STRUCTURE

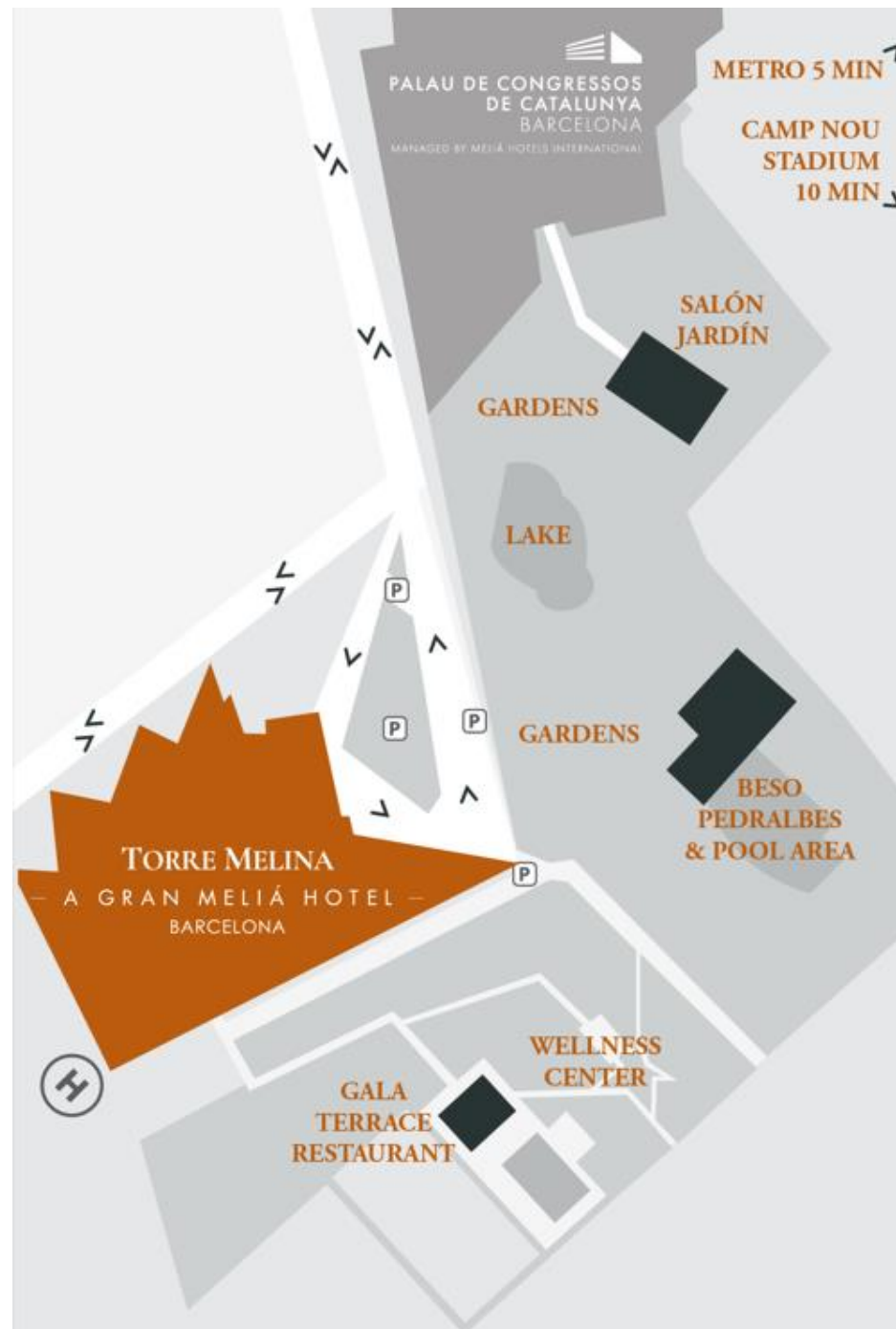

# TORRE MELINA - MEETING ROOMS

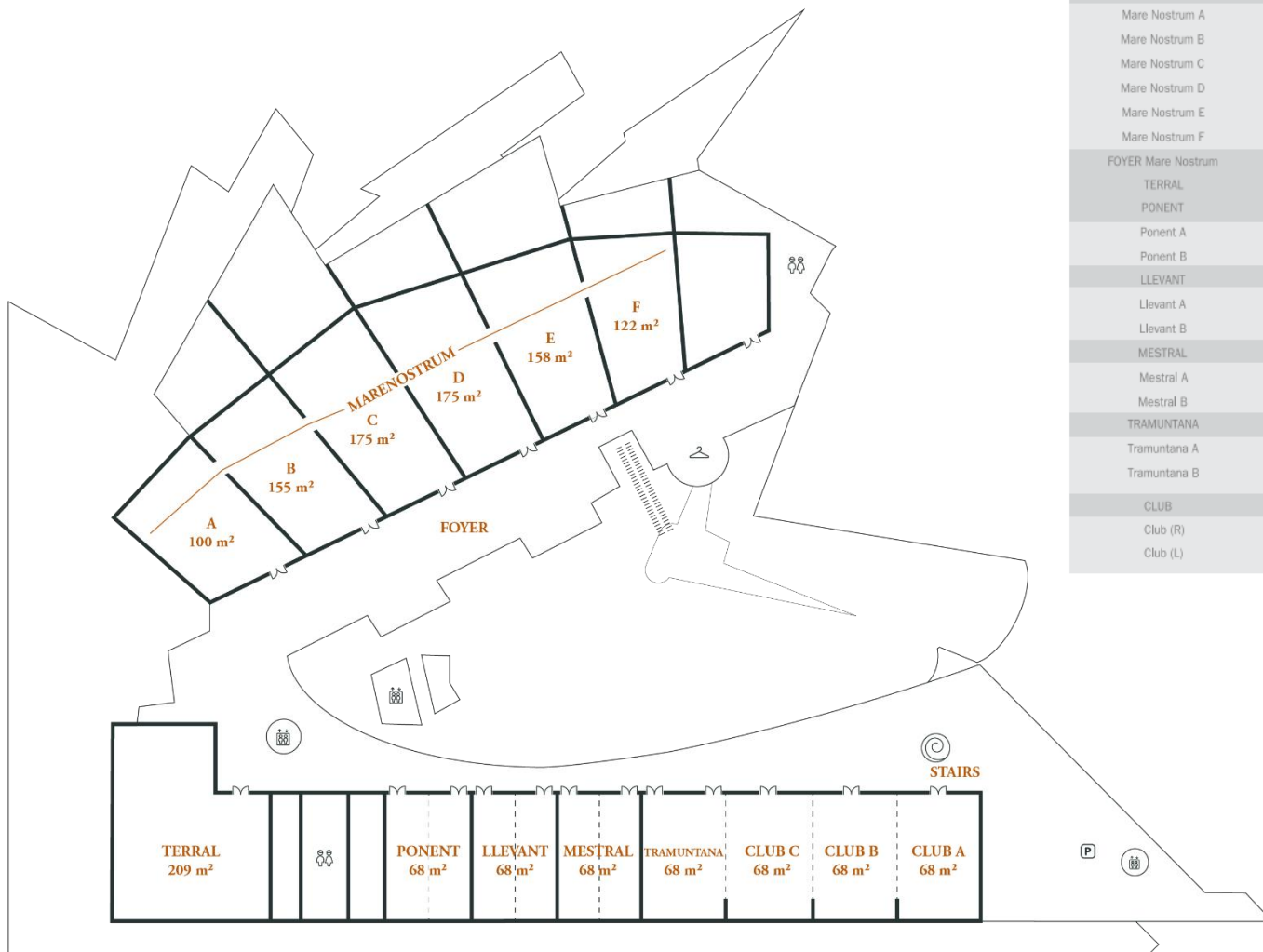

MEETING ROOM	SQ.M.	SQ.FT	Height(m)	Length(m)	Width(m)	Banquet	Cocktail	*U*Shape	Cabaret	School	Theater
MARE NOSTRUM	893,26	9,611,45	4	irregular	irregular	620	886	N/S	488	500	886
Mare Nostrum A	100	1,076	4	irregular	irregular	60	80	36	48	45	80
Mare Nostrum B	155,09	1,668,76	4	irregular	irregular	110	130	42	72	72	132
Mare Nostrum C	174,68	1,879,55	4	irregular	irregular	120	150	42	104	96	174
Mare Nostrum D	179,94	1,936,15	4	irregular	irregular	130	150	42	104	120	180
Mare Nostrum E	158,3	1,703,3	4	irregular	irregular	110	150	42	88	108	160
Mare Nostrum F	125,25	1,347,69	4	irregular	irregular	90	100	42	72	60	100
FOYER Mare Nostrum	467	5,049,34	2,5	irregular	irregular	N/A	300	N/A	N/A	N/A	N/A
TERRAL	203,12	2,185,57	2,48	17,59	14,95	140	150	34	64	48	100
PONENT	67,09	721,87	-	-	-	40	40	24	32	24	40
Ponent A	33,63	361,85	2,36	8,6	4,05	20	20	15	16	16	25
Ponent B	33,46	360,02	2,36	8,6	4,05	20	20	15	16	16	25
LLEVANT	66,96	718,47	2,36	-	-	40	40	24	32	24	40
Llevant A	33,43	359,7	2,36	8,6	4,05	20	20	15	16	16	25
Llevant B	33,53	358,77	2,36	8,6	4,05	20	20	15	16	16	25
MESTRAL	66,21	708,77	2,36	-	-	40	40	24	32	24	40
Mestral A	33,21	355,67	2,36	8,6	4,05	20	20	15	16	16	25
Mestral B	33	353,1	2,36	8,6	4,05	20	20	15	16	16	25
TRAMUNTANA	67,48	785,48	2,36	-	-	40	40	24	32	24	40
Tramuntana A	34,29	430,4	2,36	8,6	4,05	20	20	15	16	16	25
Tramuntana B	33,19	355,08	2,36	8,6	4,05	20	20	15	16	16	25
CLUB	204	2,194,94	-	-	-	-	100	N/A	N/A	N/A	N/A
Club (R)	67,08	721,78	2,37	8,7	7,8	N/A	N/A	18	N/A	N/A	N/A
Club (L)	67,99	731,57	2,37	8,7	7,75	30	30	24	24	24	40





# PALAU DE CONGRESSOS DE CATALUNYA BARCELONA

MANAGED BY MELIÀ HOTELS INTERNATIONAL

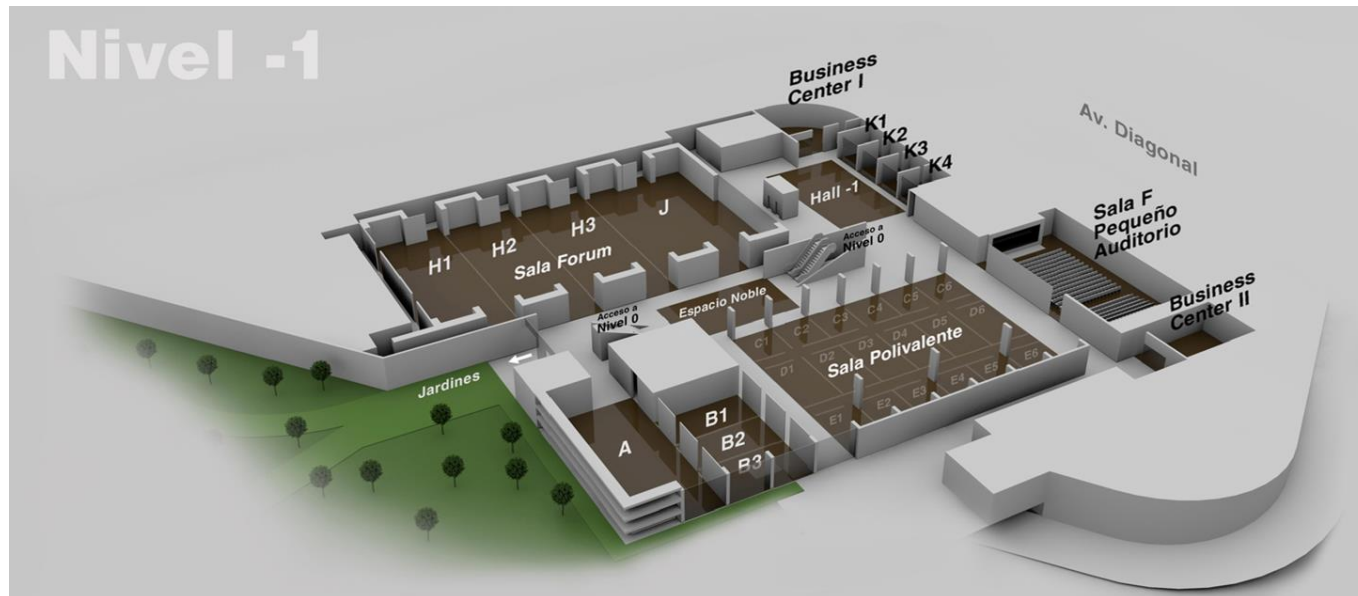



# 01

## DIAGONAL LEVEL

## ENTRANCE & MAIN HALL

	ENTRANCE & MAIN HALL
SURFACE (sqm)	460

## FOYER 0

CAPACITY	FOYER 0
BANQUET	150
COCKTAIL	250

	FOYER 0
HEIGHT	4,00
SURFACE	420

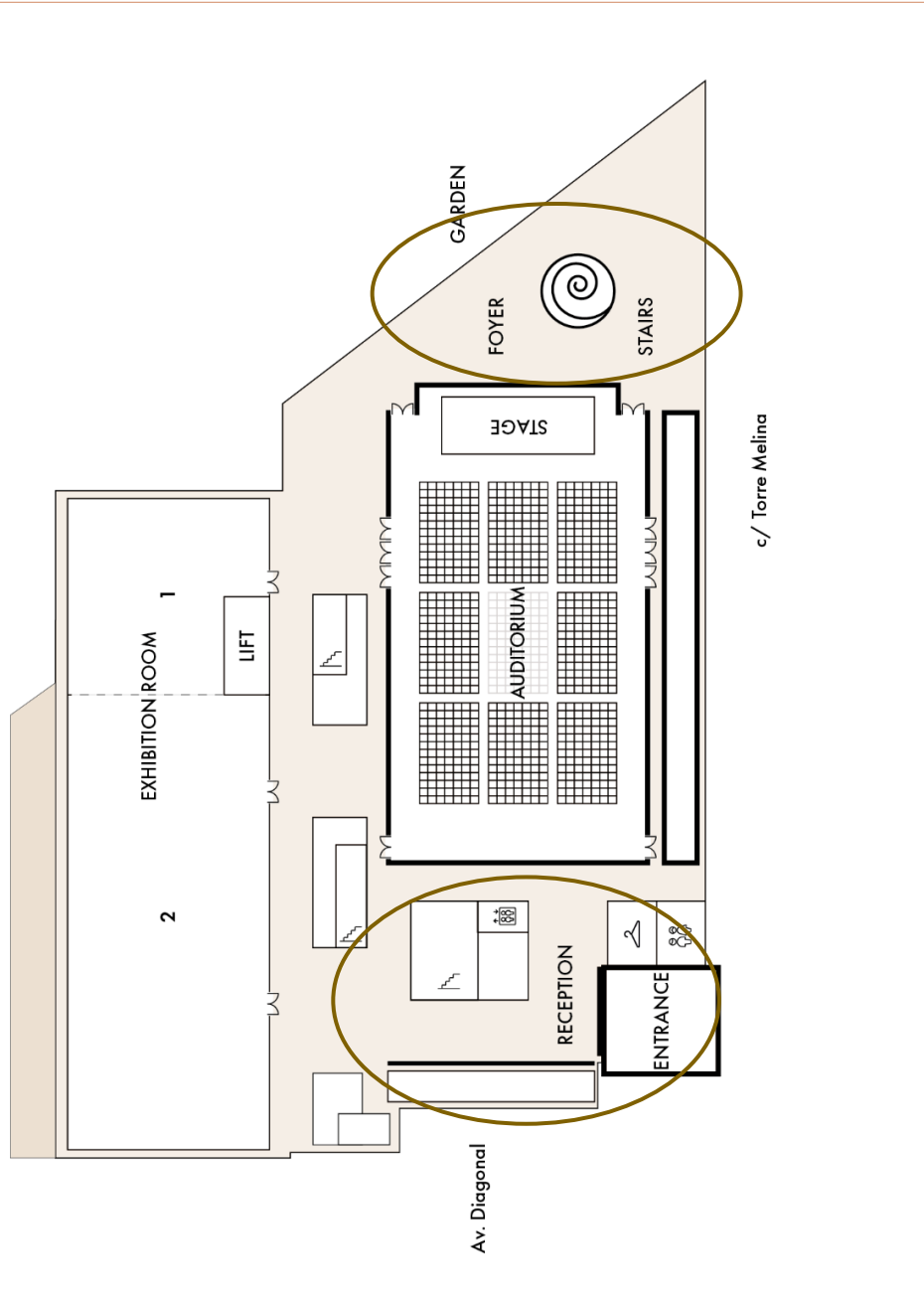
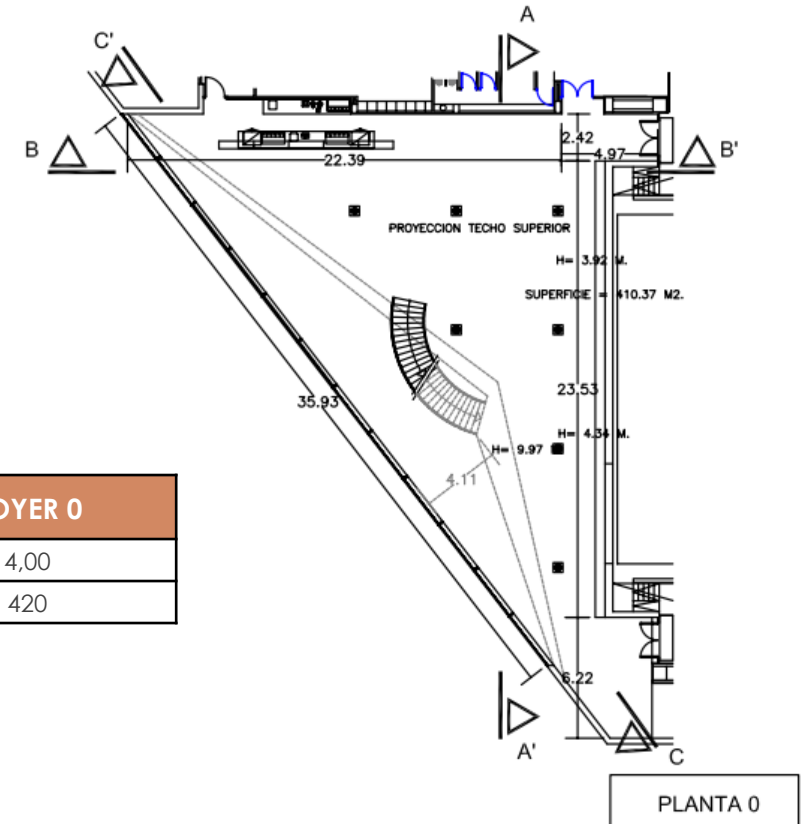

## AUDITORIUM – TOTAL CAPACITY 1897 SEATS

AUDITORIUM	PLATEA	AMPHITHEATRE	BOXES
THEATRE	1369 (925 up to curtain)	320	208 (104 each one)
SCHOOL	1369 (925 up to curtain)	320	208 (104 each one)

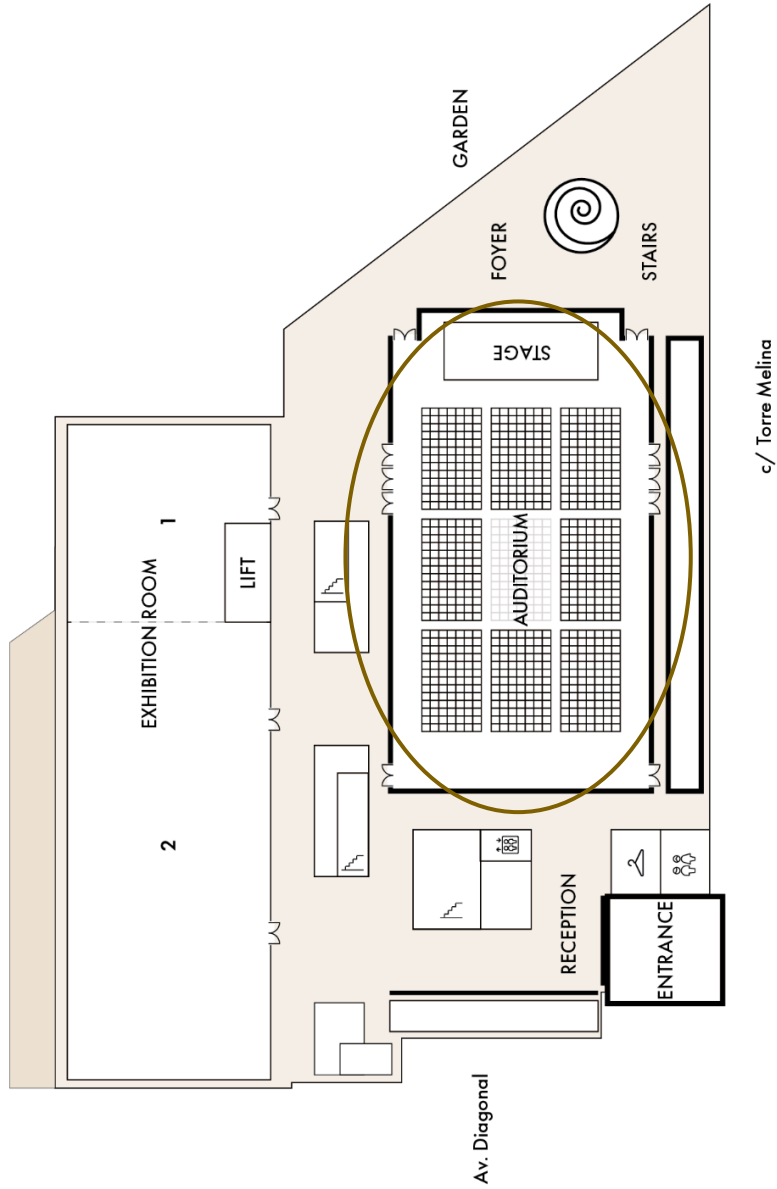
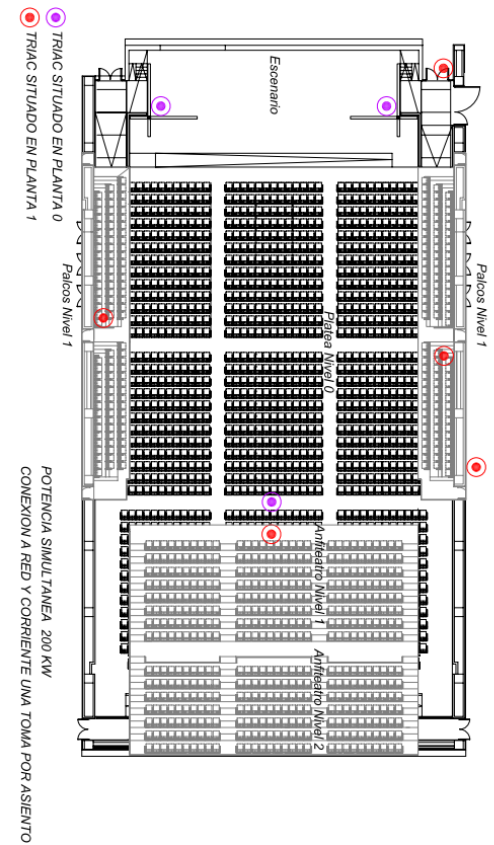
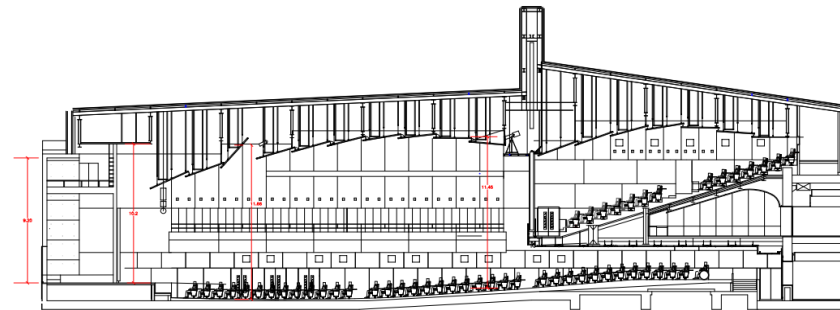



## EXPO ROOM

CAPACITY	EXPO I	EXPO II	BOTH TOGETHER
THEATER	390	1.600	2.126
SCHOOL	250	954	1.341
BANQUET	300	1.020	1.584
COCKTAIL	400	1.500	2.000

	EXPO I	EXPO II	BOTH TOGETHER
DIMENSIONS	20,83 X 19,76	55,03 X 24,45	75,86 X 24,45 / 19,76
HEIGHT	6,90	6,90	6,90
SURFACE	438	1.345,48	1.783,48

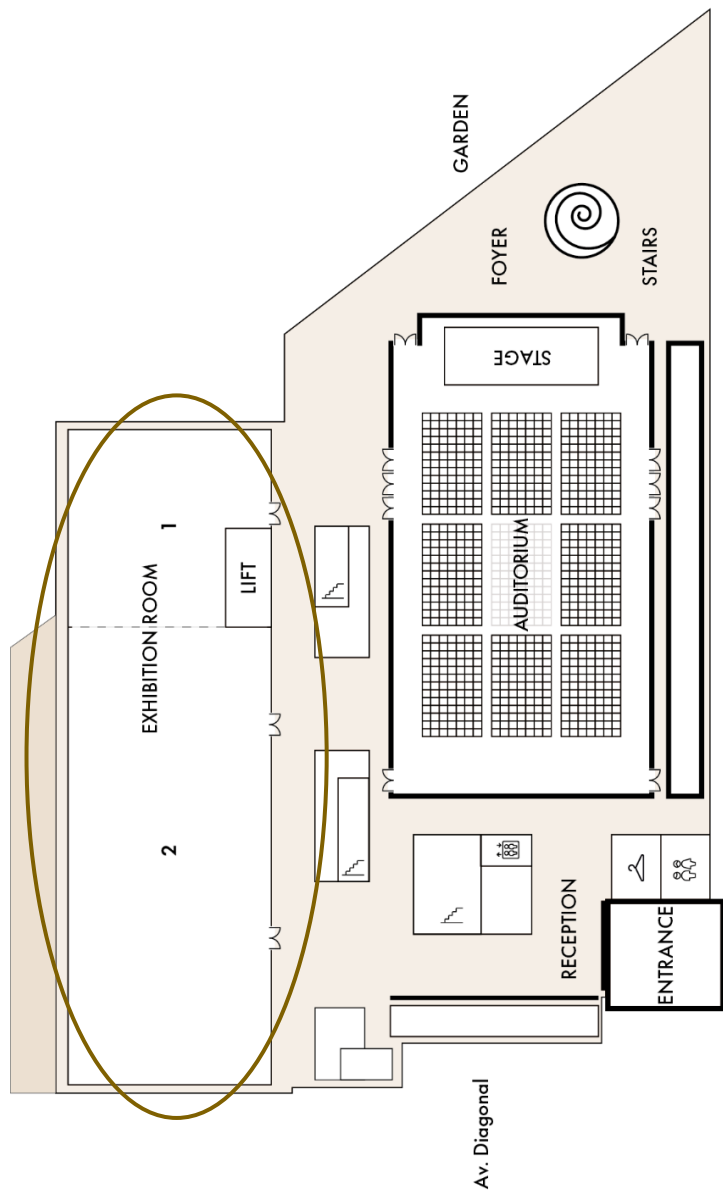
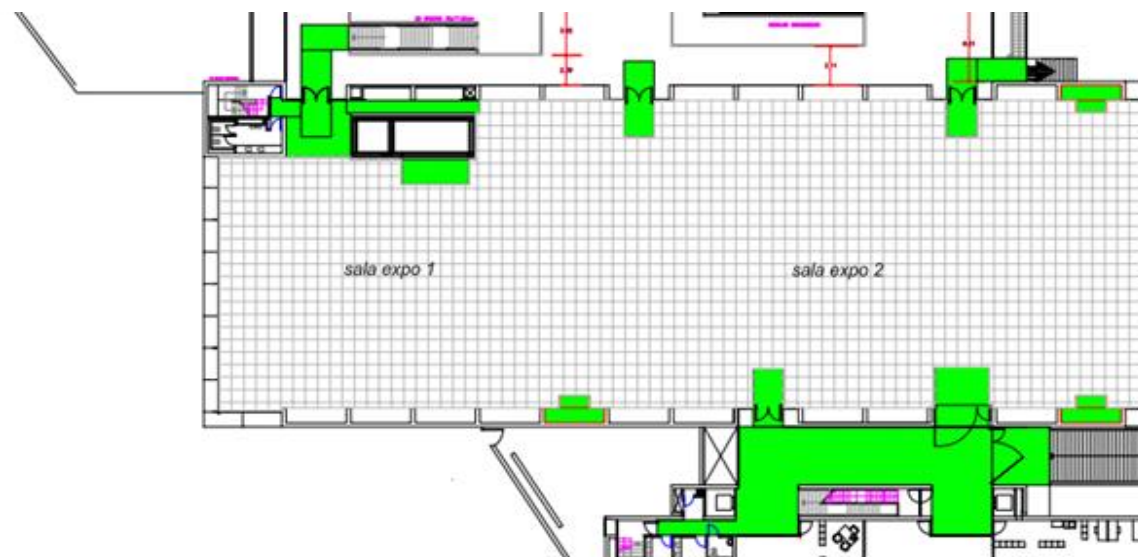





---

02

GARDEN LEVEL

---

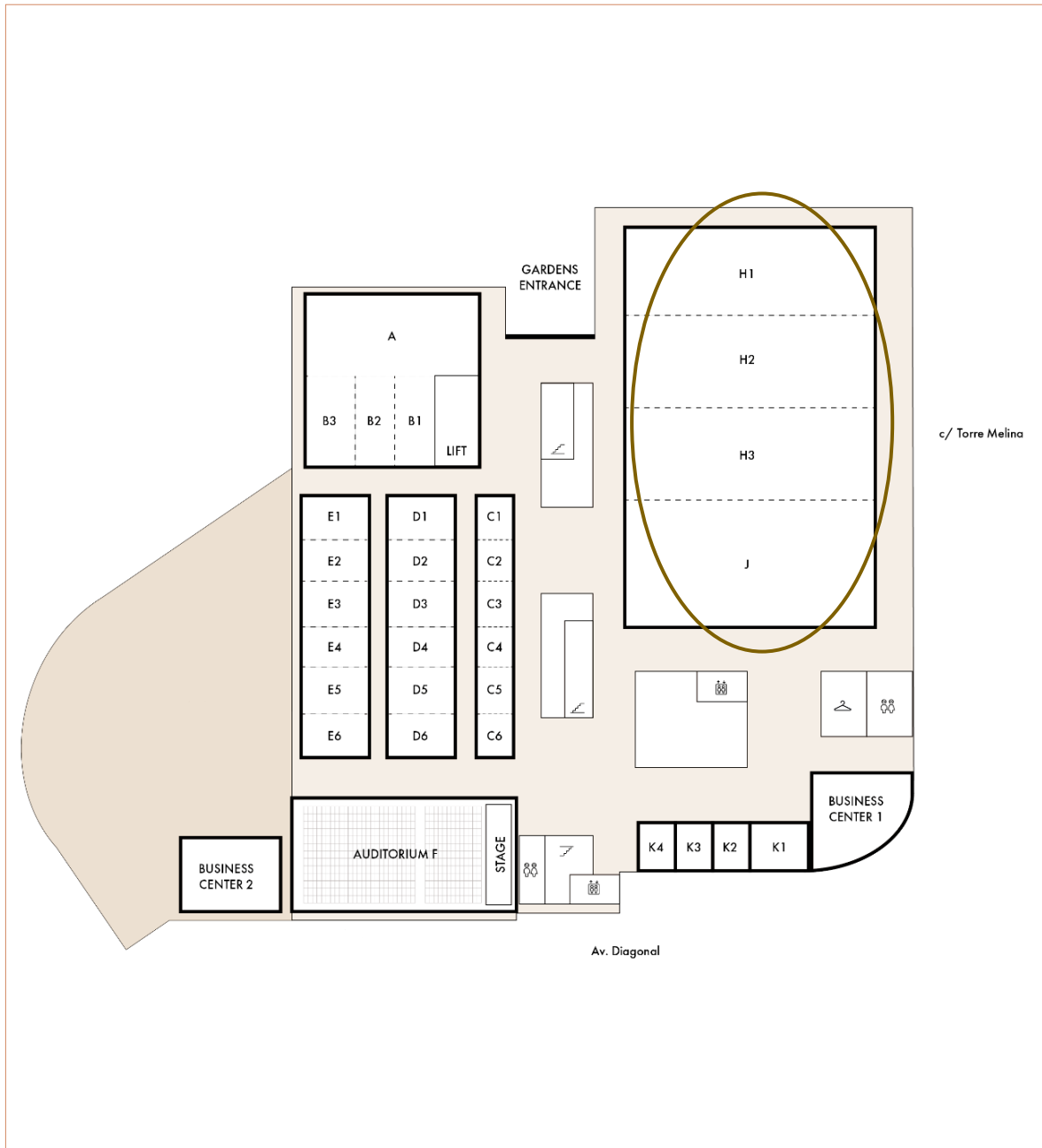

## FORUM ROOM (H1+H2+H3+J)

CAPACITY	H1, H2, H3	J
THEATRE	280	456
SCHOOL	156	294
BANQUET	216	360
COCKTAIL	250	380
U SHAPE	60	78

	H1, H2, H3	J
DIMENSIONS	10,40 x 27,58	16,46 x 27,58
HEIGHT	4,00 – 4,35	4,00 – 4,35
SURFACE	270,72 sqm (por unidad)	428sqm

COMBINATIONS	SURFACE (SQM)	THEATRE	SCHOOL	BANQUET	COCKTAIL	U SHAPE
H1 + H2 / H2 +H3	541,44	546	330	432	500	93
H1 + H2 + H3	812,16	800	540	648	800	123
H3 + J	698,72	756	420	576	600	102
H1 + H2 + H3 + J	1240,16	1480	840	1008	1100	207



c/ Torre Melina

Av. Diagonal

CAPACITY	Cs	Ds	Es
THEATRE	20	42	30
SCHOOL	12	30	18
BANQUET	20	30	20
COCKTAIL	15	30	20
U SHAPE	12	24	12

SURFACE (SQM)	C1	C2	C3	C4	C5	C6
	25,84	25,11	25,11	25,11	25,11	25,84
	D1	D2	D3	D4	D5	D6
	46,00	44,70	44,70	44,70	44,70	46,00
	E1	E2	E3	E4	E5	E6
38,80	37,96	37,96	37,96	37,96	38,80	

### POLYVALENT ROOM (Cs + Ds + Es)

COMBINATIONS	SURFACE (sqm)	HEIGH (M)	THEATRE	SCHOOL	BANQUET	COCKTAIL	U SHAPE
<b>C1+C2 / C5 + C6</b>	50,95	3,60 - 3,95	40	24	20	50	27
<b>C2 + C3 / C3 + C4 / C4 + C5</b>	50,22	3,60 - 3,95	40	24	20	50	27
<b>C1+C2+C3/C4+C5+C6</b>	76,06	3,60 - 3,95	60	36	60	60	39
<b>C2+C3+C4/C3+C4+C5</b>	75,33	3,60 - 3,95	60	36	60	60	39

<b>D1+D2 / D5 + D6</b>	90,70	3,60 - 3,95	104	48	40	80	36
<b>D2 + D3 / D3 + D4 / D4 + D5</b>	89,40	3,60 - 3,95	104	48	40	80	36
<b>D1+D2+D3/D4+D5+D6</b>	135,40	3,60 - 3,95	170	80	90	100	48
<b>D2+D3+D4/D3+D4+D5</b>	134,10	3,60 - 3,95	170	80	90	100	48

<b>E1+E2 / E5 + E6</b>	76,76	3,60 - 3,95	72	36	40	50	30
<b>E2 + E3 / E3 + E4 / E4 + E5</b>	75,92	3,60 - 3,95	72	36	40	50	30
<b>E1+E2+E3/E4+E5+E6</b>	114,72	3,60 - 3,95	115	54	60	90	48
<b>E2+E3+E4/E3+E4+E5</b>	113,88	3,60 - 3,95	115	54	60	90	48

<b>POLYVALENT ROOM</b>	1058,00	3,60 - 3,95			800	1000	
------------------------	---------	-------------	--	--	-----	------	--

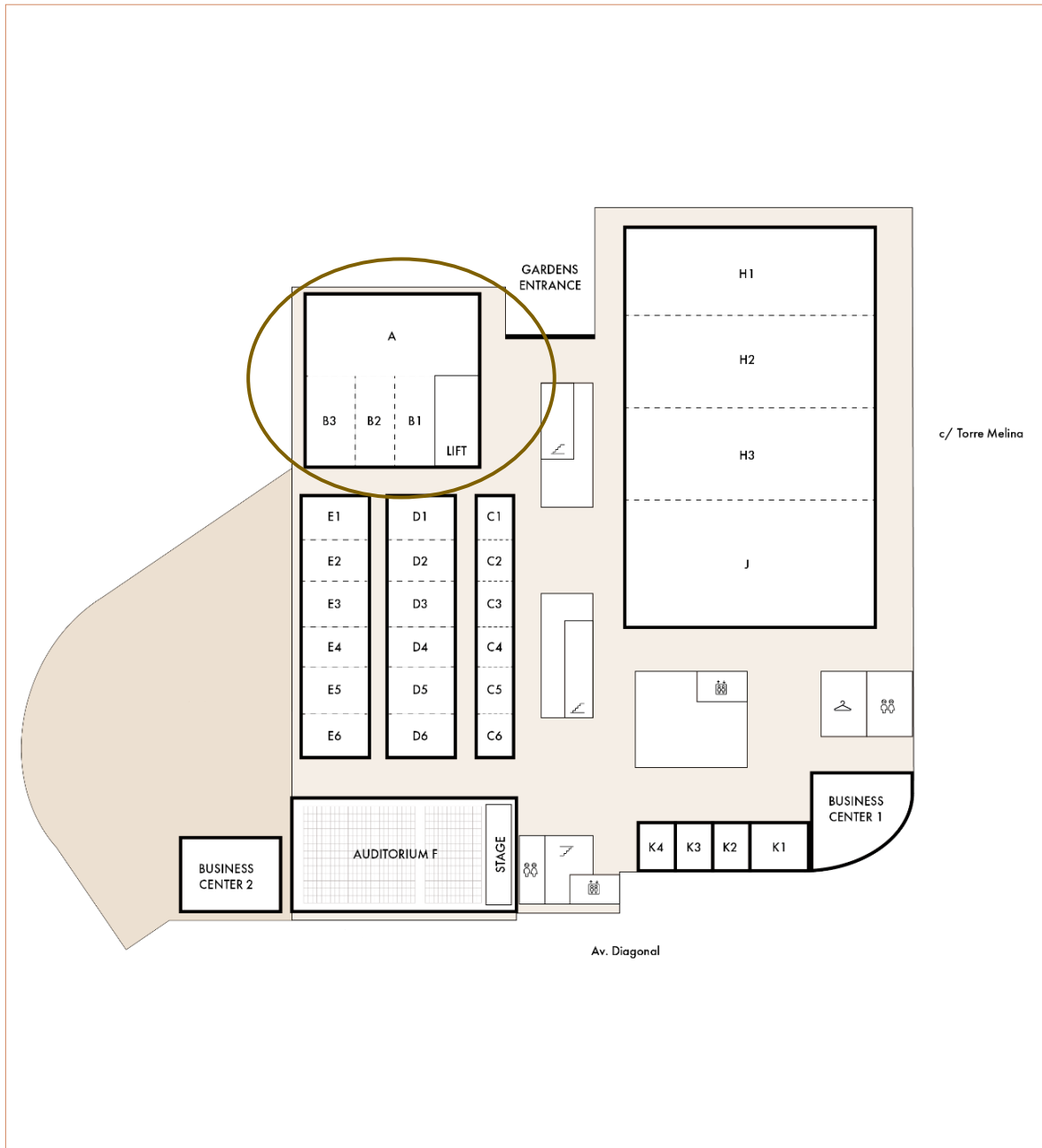

c/ Torre Melina

## ROOMS "A" + "B"

CAPACITY	A	B1, B2, B3
THEATRE	200	45
SCHOOL	120	30
BANQUET	140	30
COCKTAIL	200	45
U SHAPE	45	27

	A	B1	B2	B3
DIMENSIONS	10,32 x 20,17	10,55 x 4,74	10,55 x 4,74	10,55 x 5,89
HEIGHT	3,60 - 3,95	3,6	3,6	3,6
SURFACE	208,15	50	50	62,14



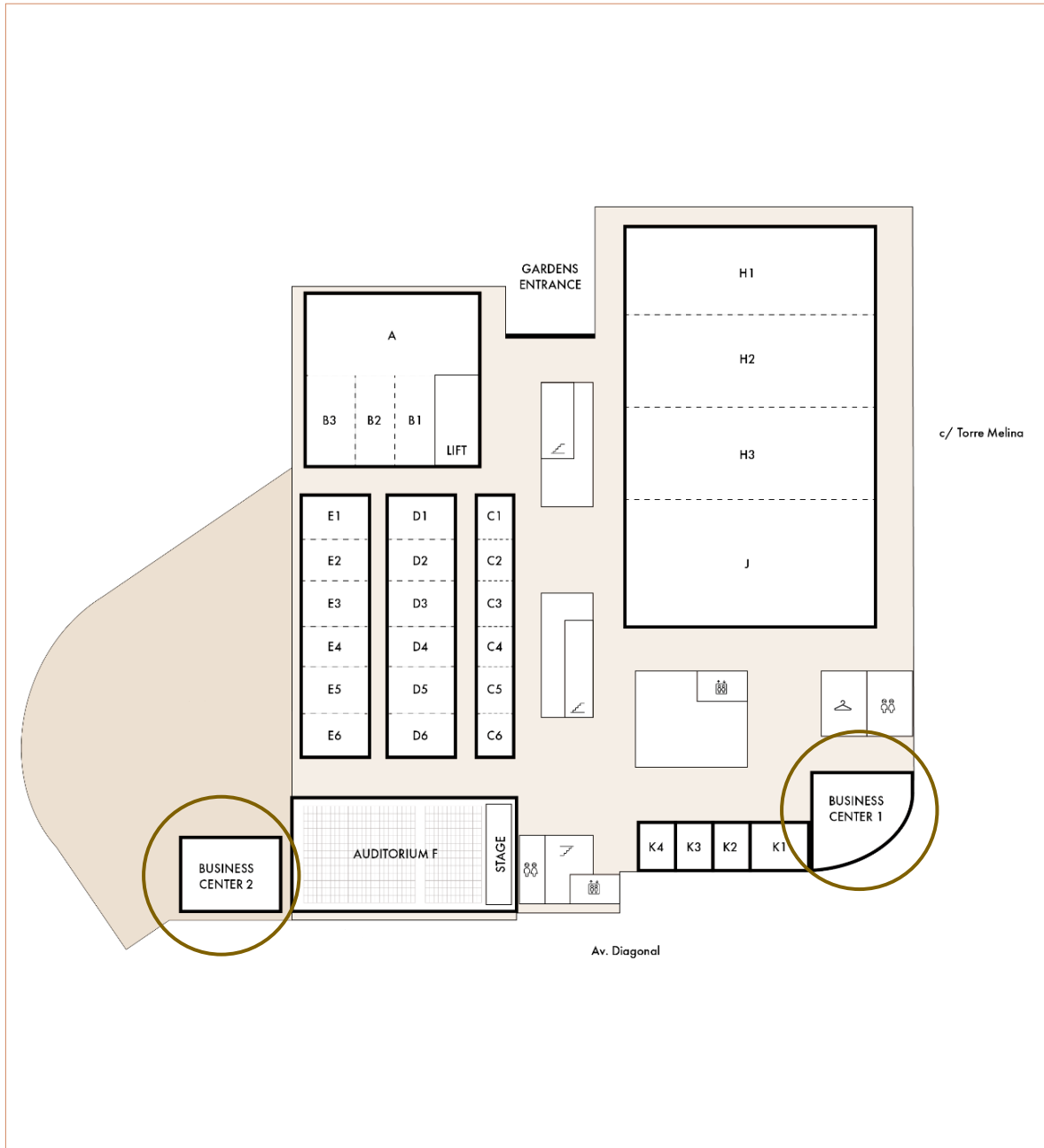

## BUSINESS CENTER | AND ||

	BCI	BCII
DIMENSIONS	Ver plano	9,28 X 7,13
HEIGHT	3,57	1,95 - 3,60
SURFACE	104,43	66

CAPACITY	BC I	BCII
THEATRE	40	24
SCHOOL	24	18
BANQUET	30	30
COCKTAIL	40	40
U SHAPE	20	15

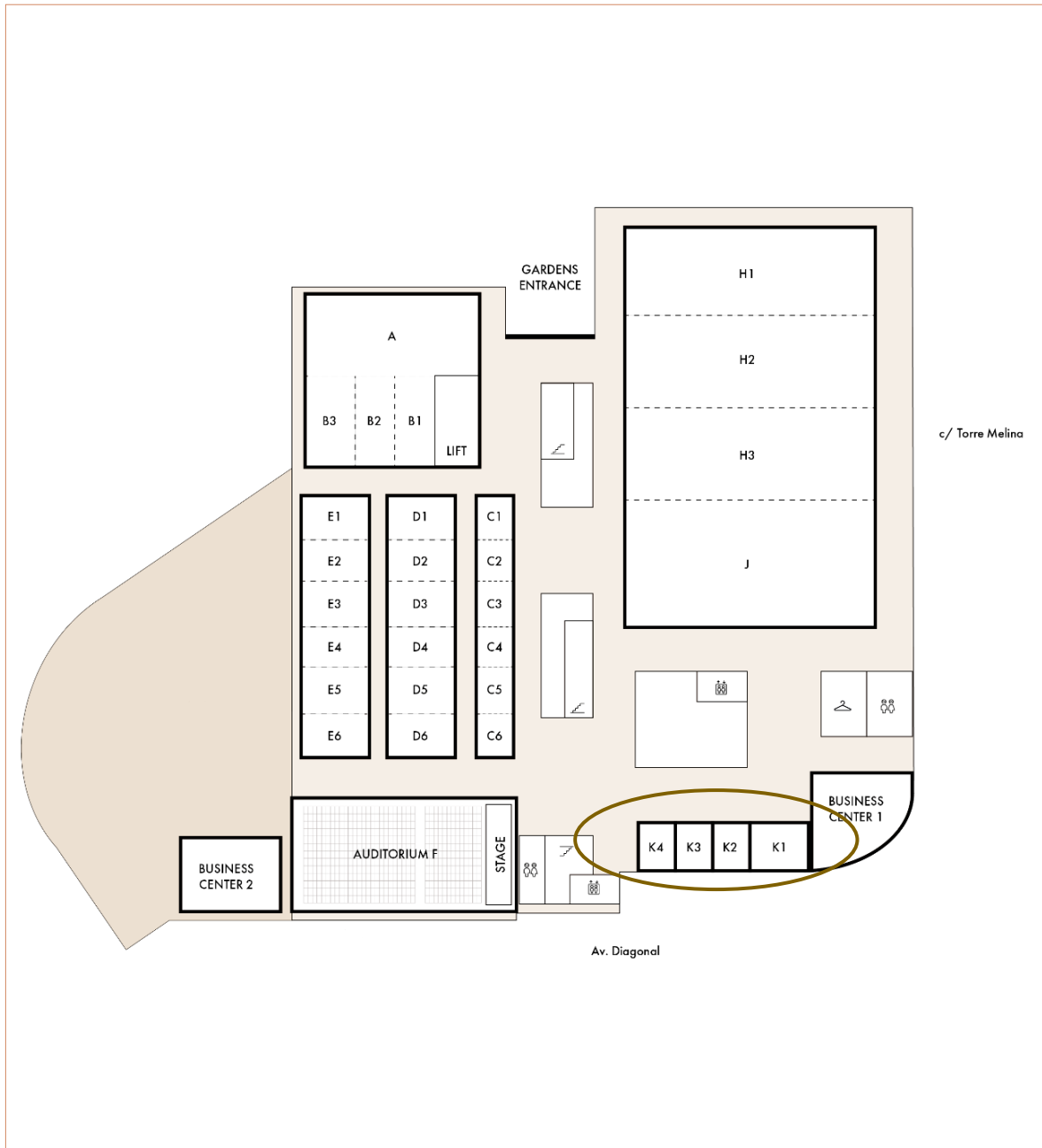

## ROOMS "K"

	K1	K2	K3	K4
DIMENSIONS	5,85 X 4,64	5,85 X 4,61	5,52 X 4,61	5,52 X 4,56
HEIGHT	3,00	3,00	3,00	3,00
SURFACE	27,12	26,95	25,42	25,2

CAPACITIES	KS
THEATRE	15
SCHOOL	12
BANQUET	10
COCKTAIL	15
U SHAPE	9

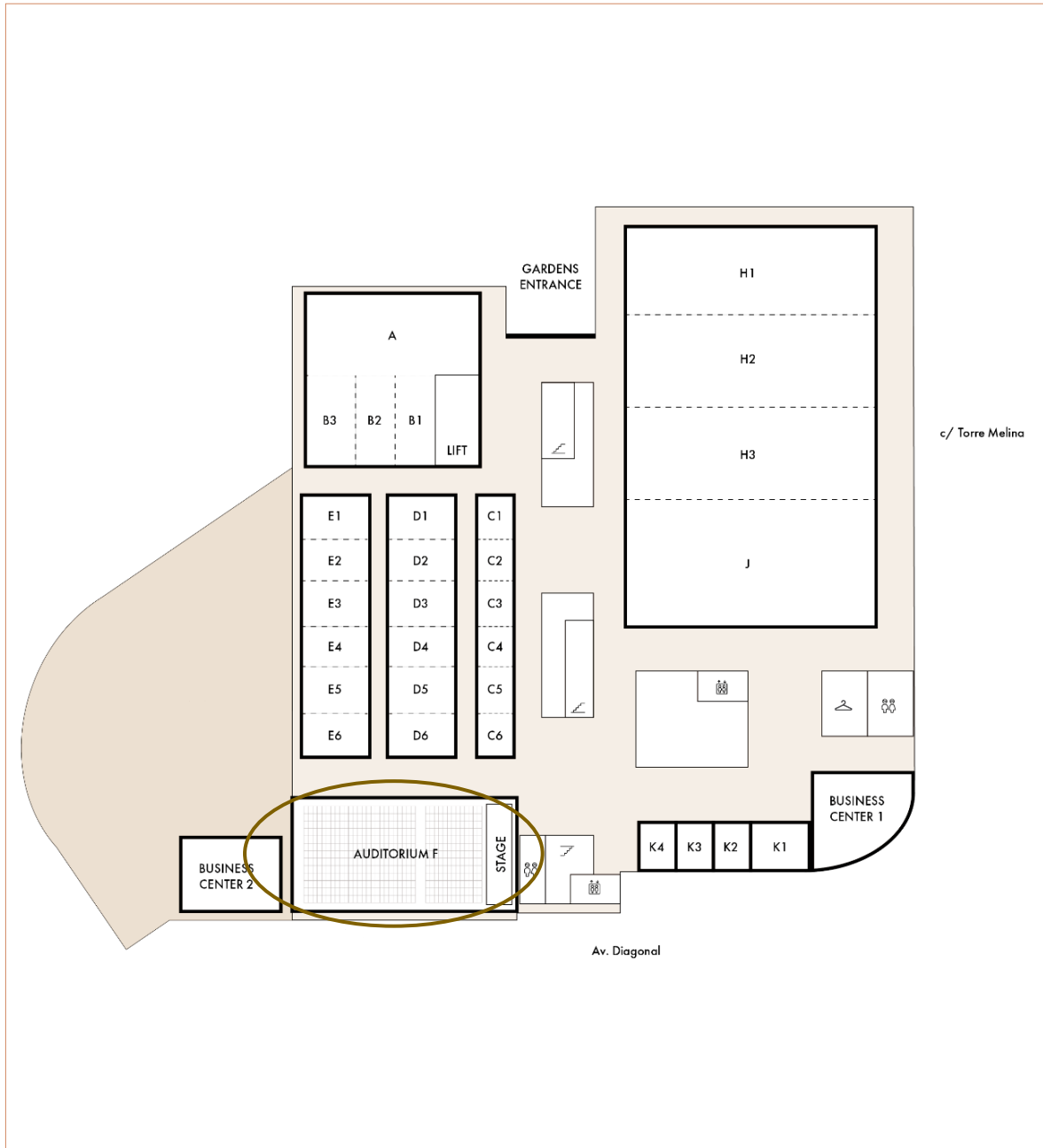

## ROOM "F"

	F ROOM
DIMENSIONS	23,20 X 12,25
HEIGHT	3,57
SURFACE	296

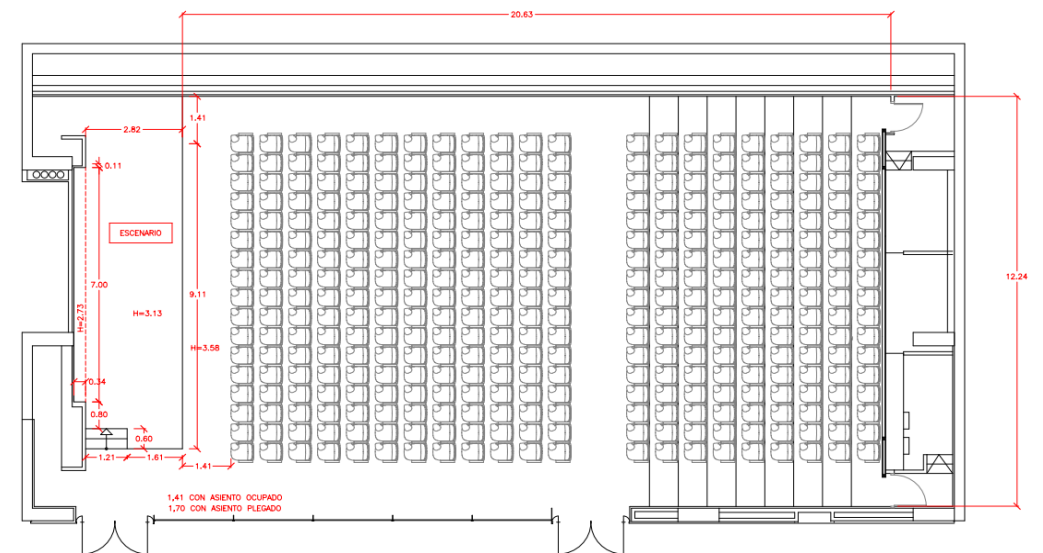
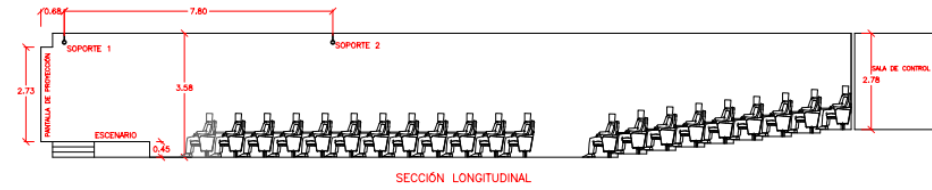

SALA F

“NOBLE SPACE” AND “HALL”

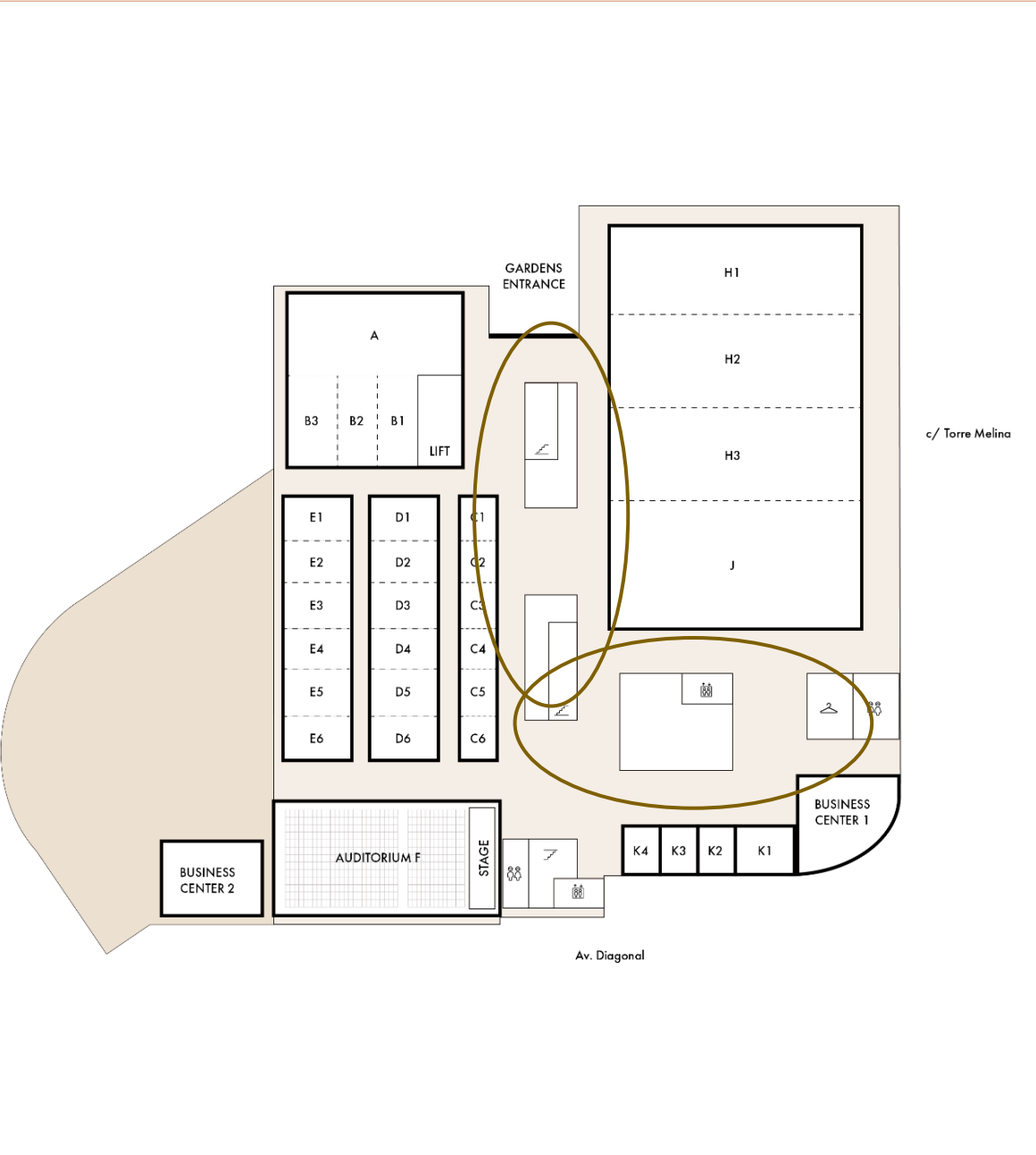

	HALL -1	NOBLE SPACE
SURFACE m <sup>2</sup>	657,51	1037,25